

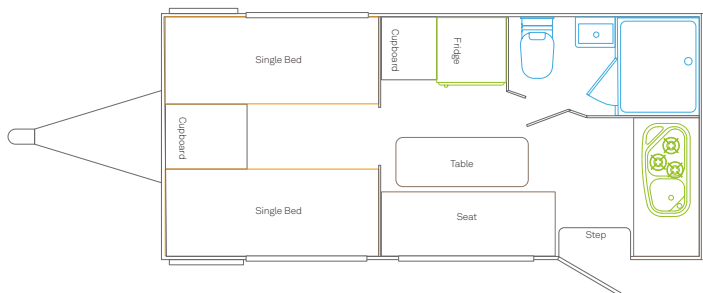

# Razor X1

RB16'1 (Single Beds)



CHASSIS	LENGTH MM	WIDTH MM	HEIGHT MM	TARE WEIGHT	ATM WEIGHT	GTM WEIGHT
---------	-----------	----------	-----------	-------------	------------	------------

RB 16'1 (Single Beds)	4877	2285	2870	2139	2639	2467
-----------------------	------	------	------	------	------	------

WEIGHTS MAY VARY

RB16'1 (Queen Bed)

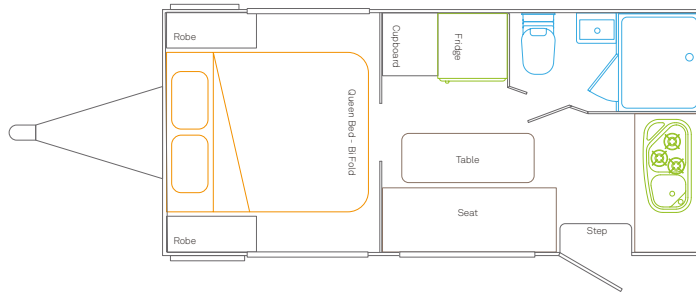

CHASSIS	LENGTH MM	WIDTH MM	HEIGHT MM	TARE WEIGHT	ATM WEIGHT	GTM WEIGHT
---------	-----------	----------	-----------	-------------	------------	------------

RB 16'1 (Queen Bed)	4877	2285	2870	2139	2639	2467
---------------------	------	------	------	------	------	------

WEIGHTS MAY VARY

## CHASSIS

- 12" Brakes
- Axle Straight
- Bumper Bar Straight
- Chassis Supagal
- D035 Hitch
- Drop Down Jacks
- Electric Brakes
- Honeycomb Composite Floor
- Jockey Wheel 8" - single wide clamp
- Lockable Coupling with Safety Chains
- Spare Wheel Bolt On
- Suspension - Alko Enduro Outback 2700kg
- Tyres 245x16"

## ELECTRICAL

- 12 Pin Plug
- A/C Roof Dometic CAL 242R
- Anderson Plug x1
- Antenna LPDA
- Awning Light (Black)
- Batteries 2 x 105amp & Charger
- Breakaway
- CD/Radio/MP3 & Speakers x2

- Fridge Thetford N614E 184Lt
- Genius Battery Management System
- Handle Light External (Black)
- LCD/DVD Combo 24"
- LED Internal Square Lights
- LED Lighting Internal & External
- Light in Tunnel Boot
- Microwave
- Powerpoint External Black
- Rangehood 12v
- Rear Triple Light Combo
- Smoke Detector
- Solar Panels 150w x 2 and 30amp Regulator

## INTERIOR

- Bathroom Accessories
- Cutlery Tray
- Drawers Metal Sided
- Fire Extinguisher Recessed
- Laminex Benchtops
- Laminex Splashback
- Mattress Queen Innerspring
- OHC with Gas Struts
- Quilt Cover Set

- Step Fibreglass
- Towel/Apron Set

## EXTERIOR

- Access Doors (Black Frame/Infill)
- Annex Roller On Main Door
- Awning 8300 White Arms/Granite Canvas
- Checker Plate Front Charcoal
- Checker Plate Sides Charcoal 600mm
- Composite Panel White Roof
- Composite White External
- Door Stop
- Grab Handles Front/ Rear Large Black
- Hatch (Mini) x1
- Hatch 12v (W/A)
- Insulation Full
- J.Mould & Insert (Grey)
- Jack Handle
- Jack Hydraulic
- Security Door Triple Lock (Black frame/Infill)
- Slide out kitchen
- Table External Drop Down Black
- Tool Box with sliding tray to suit generator
- Tunnel Boot Galvanised

- Vents External (Black)

- Wheel Arches Galvanised
- Wheel Brace
- Wheel Spats Slim C/Plate

## PLUMBING

- Chrome Flick Mixer Tap
- City Mains Pressure Inlet
- Drain Tap Fitted to Water Tank
- External Shower
- Gas Bottle 9kg x2
- HWS Gas/Electric
- Lockable Water Filler (Black)
- Mains Pressure Tap on A/Frame
- Pump 12v
- Shower Glass Door
- Shower Mould Fibreglass
- Stove and Sink Combo
- Toilet
- Vanity Ceramic
- Water Level Indicator
- Water tank 95lt fitted w/stone guard x2

## WINDOW WARE

- Windows Double Glazed Euro Black